

CHECK VALVE

CDVN-015-SSNS

MONO-DIRECTIONAL
SPHERE TYPE

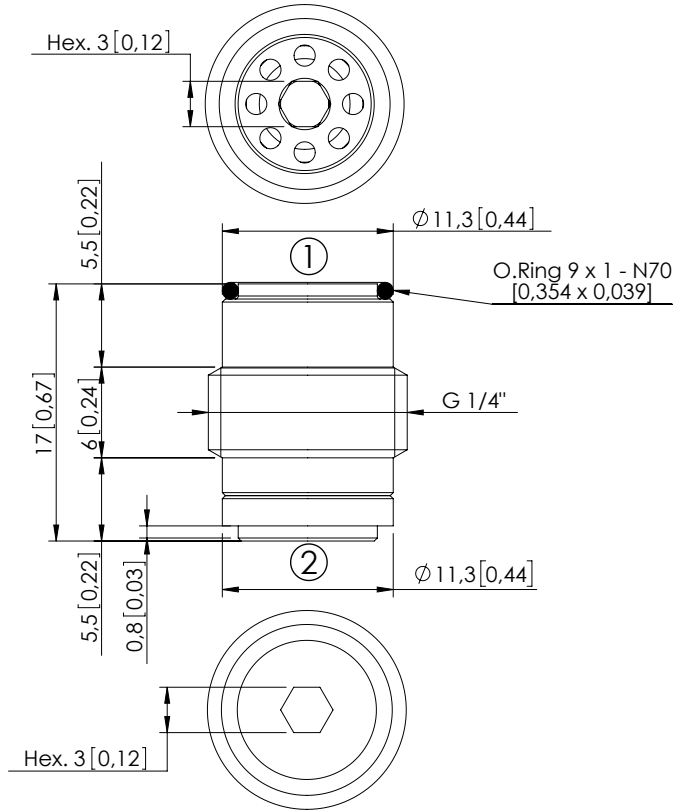

Dimensions: mm [inches]



SPECIFICATIONS

Max. operating pressure:	350 bar (5000 psi)
Rated flow:	15 l/min (4 gpm)
Cavity:	VP000309
Weight:	0,01 kg (0,02 lbs)
Contamination class to ISO 4406:	See technical spec.
Installation torque:	6 Nm (4,5 ft-lb)
MTF _a :	150 - 1200 years: See technical spec.

NOTES

Bidirectional installations. Fit O-Ring to side first inserted in cavity.

For other configurations/quick codes not available in this catalogue page please consult factory

CURVES

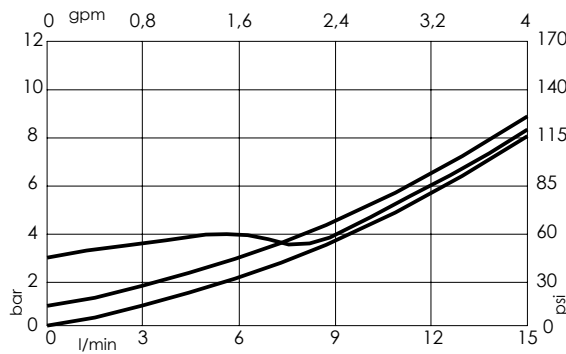

ORDERING CODES

Quick code	Description	Cracking pressure	
CD000026	CDVN-015-SSNS-FN-309-N003	3 bar (50 psi)	
CD000636	CDVN-015-SSNS-FN-309-N001	1 bar (15 psi)	
CD000043	CDVN-015-SSNS-FN-309-N000	0	